



Dishwashing

EVO Generation - Advance

DISHWASHER AD-125 SOFT

DIMENSIONS

		<u>Article</u>	<u>Packed</u>
Length	mm	665,00	870,00
Depth	mm	775,00	950,00
Height	mm	1.540,00	1.750,00
Weigth	Kg	135,00	150,00
Volumen	m3		1,45

ELECTRICITY

<u>Electric power</u>	KW	
230V -1+N		2x16+T - 63 A
230V - III		3x6+T - 40 A
400V - III+N		4x2,5+T - 25 A

WATER

Water consumption (lit/h)	144,00
Pressure (Kg/cm2)	2 ÷ 4

GAS

Not used

STEAM

Not used

AIR

Not used

LEVEL SOUND

(dB) **63,00**

DISHWASHER AD-125 SOFT

Hood type dishwasher - EVO Generation - Advance range.
 Hourly production: 65 baskets/hour - 1170 dishes/hour.
 Clearance (max ware height): 440 mm.
 Wash cycles: 55"- 75" - 120".
 GLASS cycle: special program for washing glassware, based on the specifications of hygiene and safety standard DIN 10511. Cycle of 90 seconds, with temperatures: 60 °C (wash) and 65 °C (rinse).
 Self cleaning program: it washes the chamber, draining the tank and boiler.
 SOFT version: Built-in descaling unit and timer for regeneration cycle

Made of stainless steel. Includes double skin insulated hood, external, front and side panels.
 Full double skin body and hood to isolate machine's noise from the environment.
 Counterbalanced hood.
 Double rotating wash and rinse systems made of stainless steel, above and below.
 Tray filters on the tank, made of AISI-304 stainless steel.
 Two wash pumps, 600 W each.
 Rinsing pump: 260 W. Air break system.
 Drain pump: 70 W. Drainage cycle.
 Tank with 1.8 kW heating element.
 Tank capacity: 28 litres.
 Boiler with multipower heating elements: 3 / 4,5 / 6 / 9 kW.
 Boiler capacity: 9 litres.
 Water consumption: 2.4 litres/rinse.
 Thermostatic temperature control: washing at 60°C and rinsing at 90°C.
 Thermo stop system that guarantees minimum rinsing temperature of 85°C.
 Safety thermostats.
 Built-in automatic rinse dispenser and detergent doser.
 Safety magnetic switch for hood opening.
 Adjustable legs.
 Water protection rating: IPX5
 Total power: adjustable: 4,2 ÷ 12,0 kW.
 Dimensions: 665 x 775 x 1540 mm (2050 mm open hood).

Baskets equipment: 1 x CT-10, 1 x CP-16/18 and 8 cutlery containers.

<u>Connections points</u>	<u>X</u>	<u>Y</u>	<u>Z</u>	<u>Diameter</u>	<u>Information</u>
ELECTRICITY	210	50	65		
SOFT COLD WATER	305	50	65	3/4"	
DRAIN	370	50	65	30 x 25	

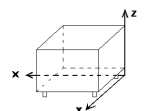

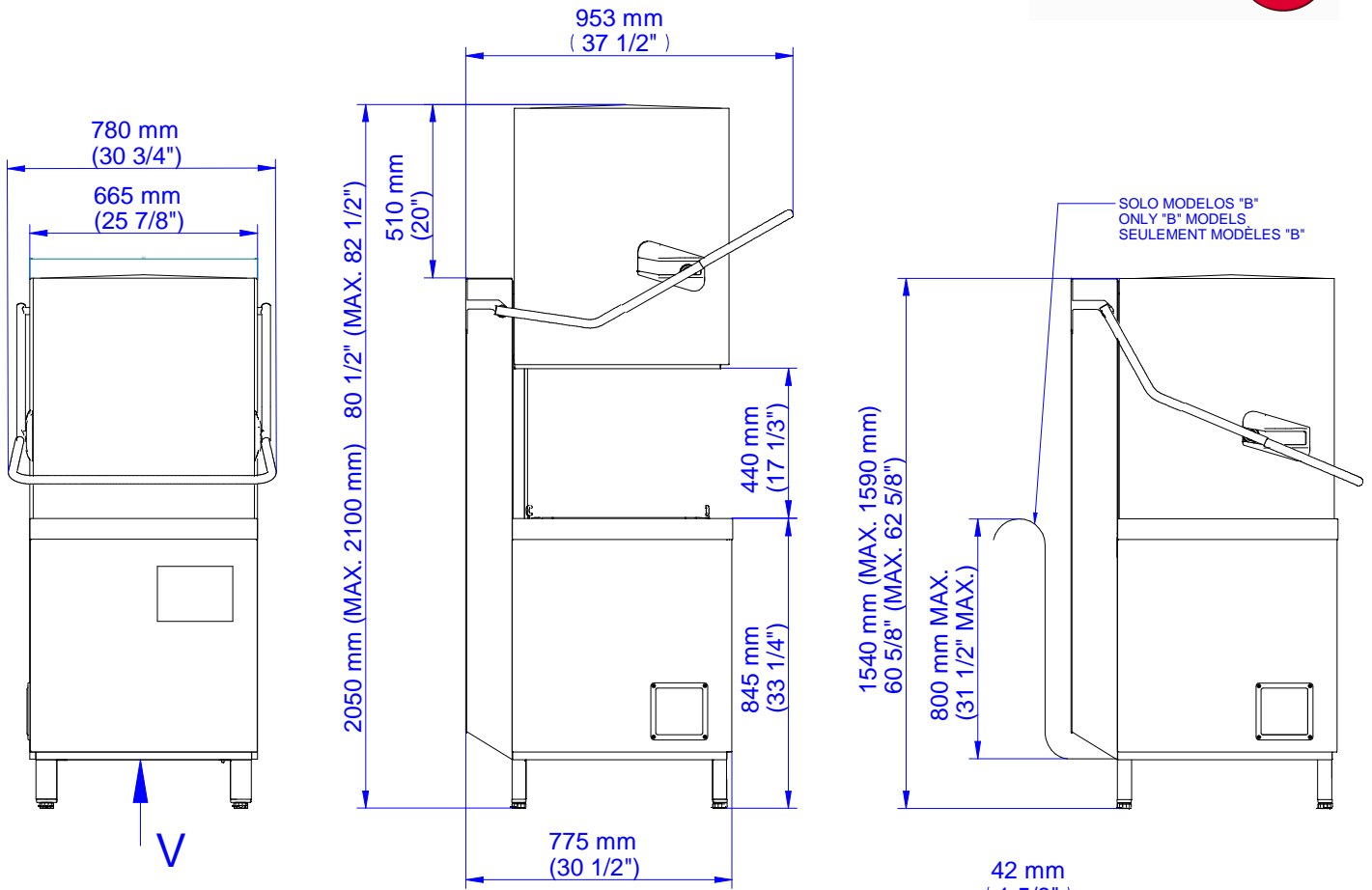

SOLO MODELOS "B"
ONLY "B" MODELS
SEULEMENT MODÈLES "B"

A: ENTRADA DE AGUA
E: ALIMENTACIÓN ELÉCTRICA
D: DESAGÜE

A: WATER INLET
E: ELECTRICAL CONNECTION
D: DRAIN

A: ARRIVÉE D'EAU
E: CONNEXION ÉLECTRIQUE
D: VIDANGE

V

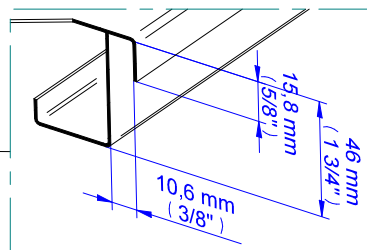
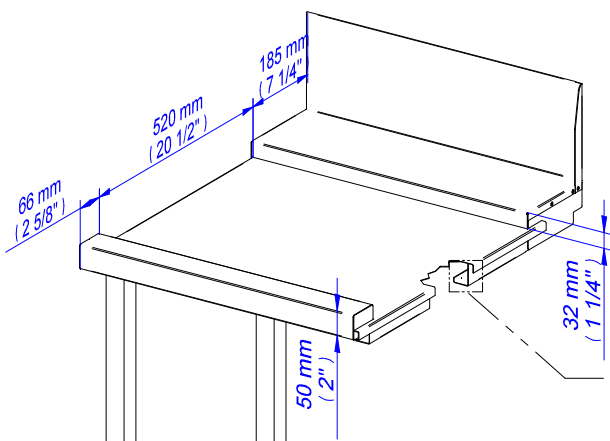
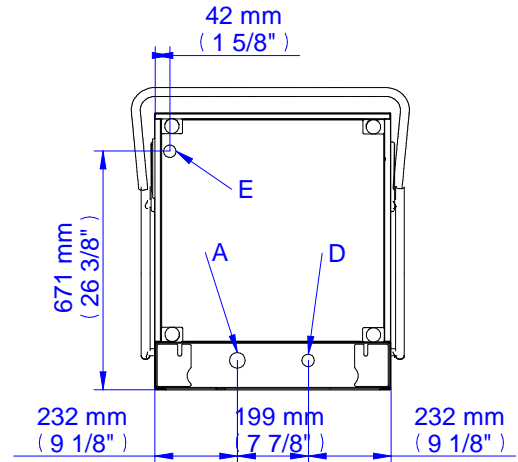

MESA
TABLE

CUBA
TANK
CUVE